

Installation Guide

Unit View

- A System (BLUE)
 - B IR receiver
 - C Red skew adjustment
 - D Green skew adjustment
 - E Blue skew adjustment
 - F Display (BLACK)
 - G VGA Gain selection (G = Gain)
 - H VGA indicator
- * Green = Power on
* Orange = VGA in

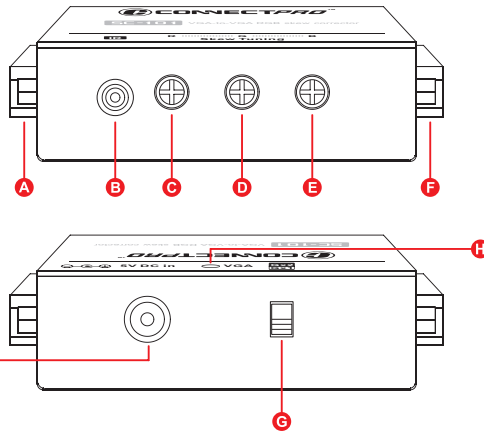

Power input regulated
DC 5V 1000 mA

Installation

Connections of the skew corrector

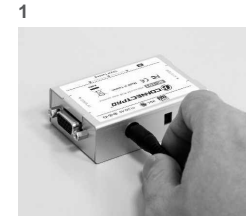

1 Connect the optional DC 5V power adaptor



2 Connect VGA cable from display to black VGA port



3 Connect VGA cable between system and blue VGA port

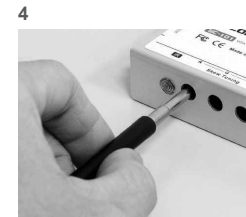

4 Skew R.G.B tuning

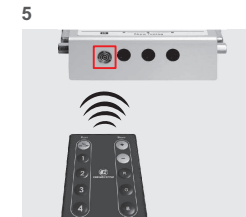

5 Skew R.G.B tuning If necessary ; use I.R remote controller to fine tune R.G.B skew

Specification

	SC-101
Functional	
Power supply	5V DC adaptor
Power on LED	Green
VGA in LED	Orange
Resolution	Up to 1920 x 1200@60 Hz
Connectors	HDB-15 Female x 2
Mechanical	
Dimensions H x W x D	22 x 45 x 70 mm (0.87 x 1.77 x 2.76 inch)
Weight	70 g (0.15 lb)
Certification	
	FCC, CE

Features & Benefits

- Easy to install for better RGB quality
- Easy to adjust VGA RGB (Red, Green, Blue) Skew separately by using a plus/minus screwdriver
- Support fine video quality up to 1920 x 1200 resolutions
- Built-in Easy Skew control via IR remote controller (optional)
- Video source could be PC, DVD player, Video extender, Video Switch, Video Splitter, or any VGA video source
- VGA GAIN x 1 or x 2 selectable
- Aluminum metal construction
- Power / video indication confirms correct operation

Application Connection Diagram

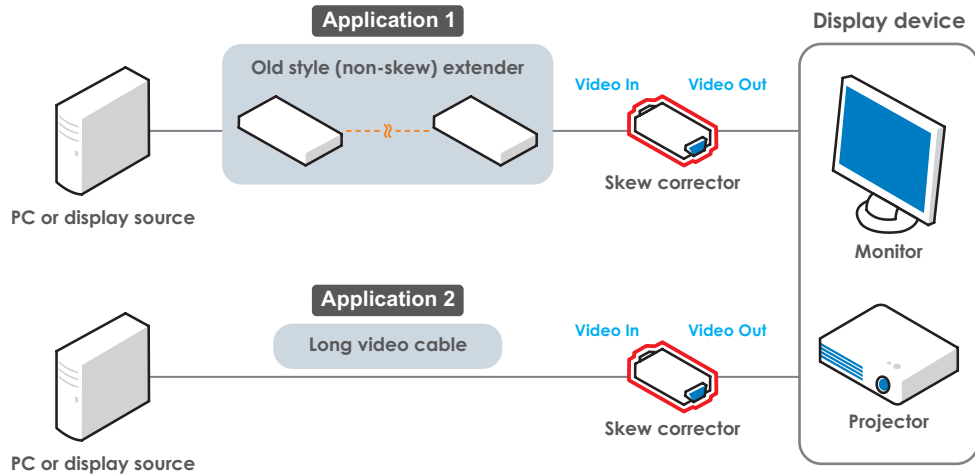

Note :

Make sure to connect the skew corrector in right direction if no display signal appears.

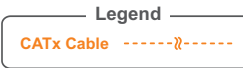

Ordering Information

Model	Description
SC-101	VGA-to-VGA RGB skew corrector
Optional part / accessory	
Cables	
CMV-202-01	1-ft Male-to-Male VGA cable
Power Adaptor	
3A-041WU05	Power supply DC 5V (1000 mA) - AC 100-120 / 220-240V for USA
3A-055WT05	Power supply DC 5V (1000 mA) - AC 100-120 / 220-240V for Europe
	* Any other interface is available up on request
IR Remote Controller	
RC-02	IR remote controller for Video / Audio Solution products



ConnectPRO - USA, Taiwan
www.connectpro.com

Corporate Office

20525 Paseo Del Prado Walnut, CA 91789, USA
 Tel +1-909-444-9288 Fax +1-909-444-9289

Design Center and Operational Hubs

7F., No.122, Sec. 1, Sanmin Rd., Banciao City,
 Taipei County 220, Taiwan, R.O.C.
 Tel +886-2-8964-2700 Fax +886-2-8964-2977