

## Installation Guide

### Product View

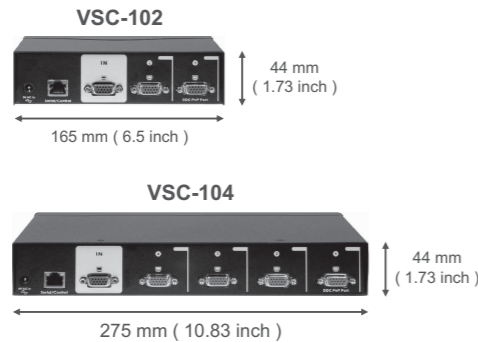

### Front & Rear View

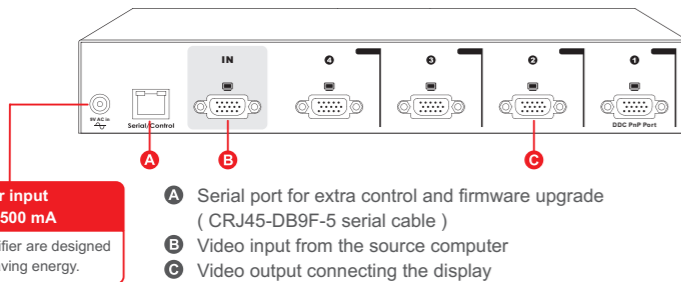
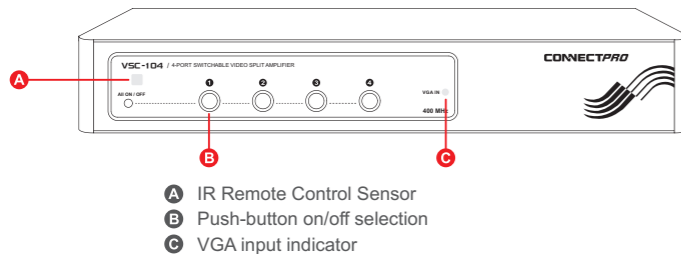

Power input  
AC 9V 500 mA

Video split amplifier are designed for effectively saving energy.

### Connect Cables



### Port Selection

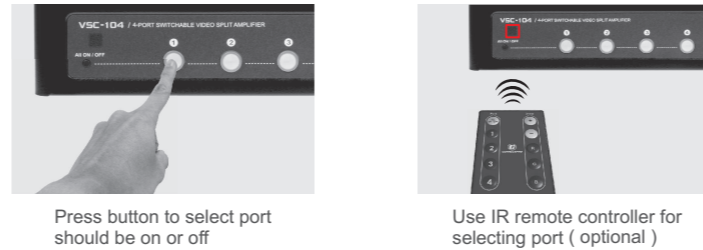

### Features & Benefits

- Channel port selectable ( all on/off or individual on/off )
- Duplicates one VGA video input to multiple outputs
- Effective transmission distance: 65M (210 ft.)
- 400 MHz with support for high resolution up to 1920 x 1440
- Applicable to VGA, SVGA, Multi-Sync monitors
- Cascaded operation for increased VGA output
- Optimized port for DDC compatible output
- Channel on/off control via push button, I.R. or serial port
- Video presentations and demonstrations
- Video exhibits and tradeshow displays
- Monitor testing and burn-in
- Business meetings and client pitches

### RS-232 Command ( Example for Windows only )

#### 1. From Windows

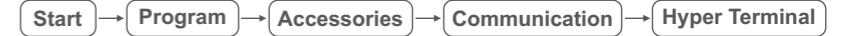

Click on "Start", choose "Program", choose "Accessories", select "Communication", then click on "Hyper Terminal"

#### 2. Set up Windows hyper terminal

- 1). In hyper terminal
  - a). create a "new connection"
  - b). Type in a name for the connection ( for example, VSC-104 ), click "OK"
- 2). Under "connect using" select "Direct to Com N ( N:1, 2, 3... )", click "OK"
- 3). Com 1 setup
  - a). Set "Bits per second" to 9600
  - b). Set "Data Bits" to 8
  - c). Set "parity check bit" to "None"
  - d). Set "Stop Bits" to 1
  - e). Set "Flow control" to "None"

Then Click OK - the hyper terminal screen should appear
- 4). Click "File", select "Properties" from the menu bar
- 5). Click on "settings", use default:
  - a). "Windows key"
  - b). "Ctrl + H(C)"
  - c). Auto detect and back scroll 500 lines
- 6). Go to "ASCII setup" and select the following items
  - a). Sending - check: "send line ends with line feed" and "echo typed characters locally" box
  - b). Receiving - check: "wrap long lines"

#### 3. After the above actions

- 1). Power on VSC unit and the control window will pop up immediately
- 2). Now you see "VSC Link", version such as "VSC-104 F/W:V 1.1" and status such as "s1v1"
- 3). You are ready to do all commands now !!

#### 4. Serial port command

- s1on : all video port on
- s1off : all video port off
- s1v0 : show all status
- s1v1 : change video port 1 status ( on/off alternate )
- s1v2 : change video port 2 status ( on/off alternate )
- s1v3 : change video port 3 status ( on/off alternate )
- s1v4 : change video port 4 status ( on/off alternate )

## Ordering Information

Model	Description
VSC-102	2-port amplifying video splitter with on/off control
VSC-104	4-port amplifying video splitter with on/off control
<b>Optional part / accessory</b>	
<b>Cables</b>	
CMV-202-03	3-ft Male-to-Male video cable
CMV-202-06	6-ft Male-to-Male video cable, special length of video cables are available ( 10-ft, 15-ft, 25-ft, 50-ft)
CRJ45-DB9F-5	5-ft serial/control and firmware upgrade cable (RJ-45 to DB9 female)
<b>Power Adaptor</b>	
PAUS-AC9V05A	Power supply AC 9V ( 500 mA ) - 110V for USA
	* Any other interface is available upon request
<b>IR Remote Controller</b>	
RC-02	IR remote controller for Video / Audio Solution products
<b>Rack Mounting Kit</b>	
RMK-1901	19" rack mounting bracket set for 4-port Video Splitter
RBK-19	19" rack mounting cable support bar

## IR Remote Control Command

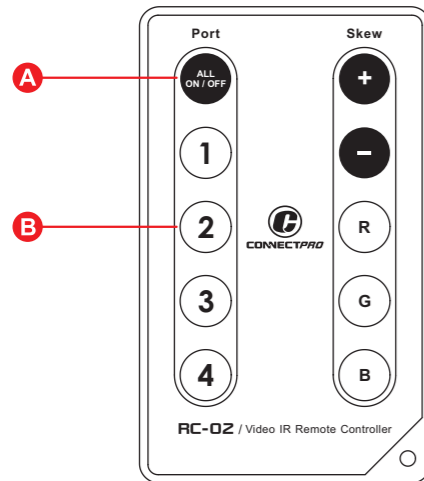

- A** All on/off selection
- B** Port on/off selection

## Specification

	VSC-102	VSC-104
<b>Functional</b>		
Display port number	2	4
Panel button control	2	4
Button LED	Selected - Green	
IR remote control	Yes ( Built-in receiver, controller RC-02 optional )	
IR remote control distance	3M	
Hot plug-and-play	Yes	
Serial control	Yes	
VGA resolution	Max 1920 x 1440 , 400 MHz , DDC1 / DDC2B	
Input connectors	HDB-15 Female x 1	HDB-15 Female x 1
Output connectors	HDB-15 Female x 2	HDB-15 Female x 4
<b>Mechanical</b>		
Height	44 mm ( 1.73 inch )	44 mm ( 1.73 inch )
Width	165 mm ( 6.5 inch )	275 mm ( 10.83 inch )
Depth	76 mm ( 2.99 inch )	131 mm ( 5.16 inch )
Weight	500 g ( 1.1 lb )	1030 g ( 2.27 lb )
<b>Environmental</b>		
Operating temp	0 to 60 °C ( 32 to 140 °F )	
Storage temp	-30 to 70 °C ( -22 to 158 °F )	
Humidity	0~80% RH, NC	
<b>Power</b>		
Operating voltage	AC 9V ( 500 mA )	
Power frequency	50-60 Hz	
Input power	AC 100-120 or 220-240V	
Power consumption	0.8 W	1.2 W
<b>Supported</b>		
Cascade	3 Layers	
DDC	DDC , DDC2 , DDC2B	
VGA	VGA , SVGA , XGA , SXGA , UXGA , QXGA	
<b>Certification</b>		
	FCC, CE	

## Limited Warranty For ConnectPRO Video / Audio Solution Product

ConnectPRO offers 1-year limited warranty for all of its Video / Audio Solution products. ConnectPRO stands behind its products assured that you're purchasing a proven technology with quality and reliability.



ConnectPRO - USA, Taiwan  
www.connectpro.com

### Corporate Office

20525 Paseo Del Prado Walnut, CA 91789, USA  
Tel +1-909-444-9288 Fax +1-909-444-9289

### Design Center and Operational Hubs

13F., No.120, Sec. 1, Sanmin Rd., Banciao Dist.,  
New Taipei City 220, Taiwan, R.O.C.  
Tel +886-2-8964-2700 Fax +886-2-8964-2977